

S-HR Propane Conversion Kit

These conversion instructions are to be used together with the installation instructions for the standard unit. This supplement is for the conversion from a standard S-HR natural gas unit to a S-HR propane unit. Each type of unit has a conversion kit specific to it because each unit has its own modulation range and specification.

The following items are included with the conversion kit:

- House pressure regulator, minimum capacity 10 kg/h / 30 m bar.
- Ceramic burner stones cassette (not with S-HR 51/51T/60).
- Restriction plate with gasket
- Keyboard and display with propane settings.
- Propane identification plates.
- Instructions leaflet.

House pressure regulator.

Fit the house pressure regulator according to the regulations.

Conversion from a natural gas unit to a propane unit should be carried out as follows:

- 1) Ceramic burner stones cassette (not with S-HR 51/51T/60);
- 2) Restriction plate;
- 3) Keyboard and display with propane settings.
The unit is to be fitted with a new keyboard and display which are supplied. So that after conversion, a keyboard and display from the natural gas unit is left over and must be returned by using the envelope in which the propane keyboard and display was supplied.
- 4) Identification plates.

1) Burnerscales (not with S-HR 51/51T/60).

In order to fit the new burnerscales, the fan unit must be removed first. Removal is carried out as follows:

- Convert the boiler before connecting it to the power supply, gas supply and central heating system;
- Remove the transparent air reservoir cover;
- Disconnect electrical wiring from the fan and the gas block;
- Unscrew the gas union under the gas block;
- Turn the two fan unit toggle rods $\frac{1}{4}$ turn to the left;
- Unscrew the air inlet silencer cross head screw on the side of the heat exchanger;
- Now remove the complete fan unit from the heat exchanger;
- Remove the existing burnerscale cassette and fit the new burnerscale cassette;
- Refit the fan unit following the reverse of the above steps.

2) Propane restriction plate

In order to fit the restriction plate, the air inlet section gas block of the fan needs to be removed.

- Unscrew the three cross head screws from the air inlet section and the gas block;
- Fit the restriction plate in the gasket;
- Re-fit the gas block to the air inlet section and ensure in doing so that the rubber gasket remains in place;
- Now re-assemble the dismantled components in reverse order.

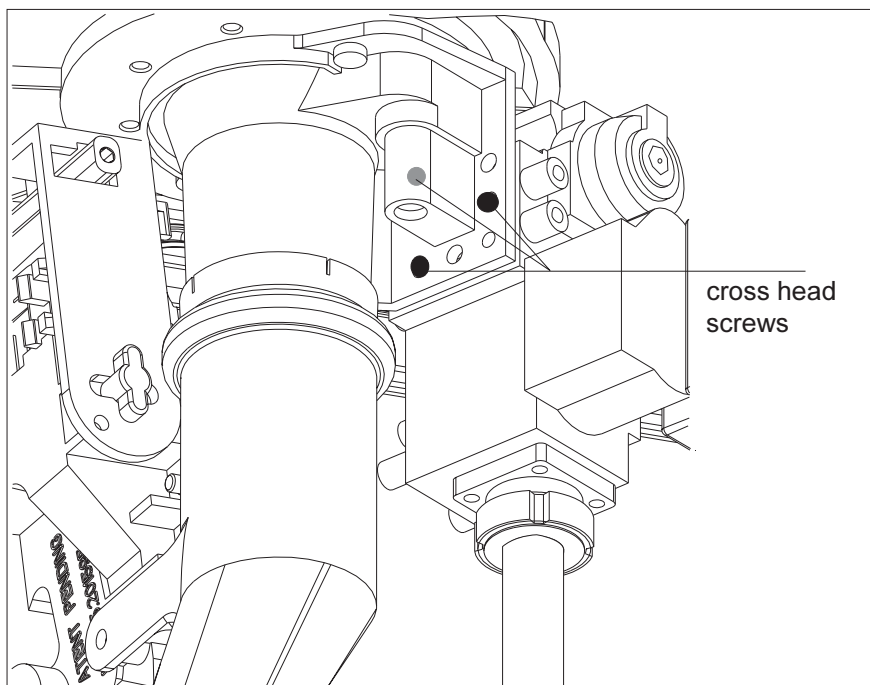

3) Keyboard and display with propane data.

The keyboard and display with propane data is to be fitted as follows:

- Open the door of the Control Tower;
- Remove the flat connecting cable from the rear of the keyboard PCB;
- Remove the keyboard PCB by unscrewing the three cross head screws;
- Now fit the propane keyboard in place of the keyboard which has been removed and fix this with the three cross head screws;
- Insert the flat cable plug in the connector block of the keyboard PCB.

4) Identification plates.

Affix the propane identification plate over the natural gas identification plate.

Conversion of the unit is now complete.

Putting into operation of the propane unit.

- Now plug the unit into the wall power point. The text **d--A** will now show on the display which means that the propane data in the display can be copied to the automatic control;
- Next, press the "Store" button in order to activate the copy function. The propane data are now loaded in the MCBA. After this, the standard text **Load** appears and the unit is now ready to operate as a propane unit.

CO₂ adjustments

With full propane tank and boiler on full load:	CO ₂ on 10 %
With half full propane tank and boiler on full load:	CO ₂ on 10,5 %
With almost empty propane tank and boiler on full load:	CO ₂ on 11 %

For further information regarding the adjustment of CO₂ and unit settings, refer to the standard installation instructions for the unit.